

MRM Stationary Medium-Expansion Foam Generator

Description

The SKUM MRM is a medium-expansion foam generator, designed for fixed installation. It converts foam liquid and water solutions into medium-expansion foam. The MRM Stationary Medium-Expansion Foam Generator is installed as part of a fire protection system that could use one or more MRM foam generators.

Application

The SKUM MRM Stationary Medium-Expansion Foam Generator is designed for land based applications. It is designed to protect flammable liquid spillage areas and locations that require a layer of medium-expansion foam, such as the following examples:

- Bunded areas
- Under dock protection
- Spill fires
- Basins and loading facilities

Features

- Stainless steel body
- Hot-dipped slip-on galvanized flange and brass nozzle
- Trouble-free installation
- Large area coverage
- Suitable for indoor and outdoor use
- Capacity up to 2,000 Lpm

Connections

- Flanged to fit DIN PN16 or ANSI B 150 lb

Figure 1: MRM dimensions

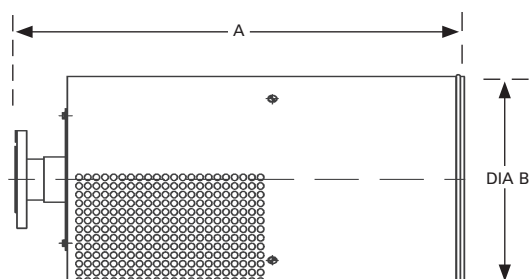

Note: For the MRM dimensions, see Table 2.



E002266

Ordering information

When ordering, specify the following information:

- Part number (see Table 1)
- Size
- Connection: DIN or ANSI
- Capacity

Table 1: Part numbers

Part No.	Description
102105114	MRM-50 DIN 200 Lpm
102105212	MRM-50 DIN 400 Lpm
102105163	MRM-50 ANSI 200 Lpm
102105261	MRM-50 ANSI 400 Lpm
102106110	MRM-65 DIN
102106215	MRM-65 ANSI
102108112	MRM-80 DIN
102108217	MRM-80 ANSI

Performance data

Table 2: Performance data

MRM model:	50F to 200		50F to 400		65F		80F	
Inlet pressure:	3 bar	5 bar	3 bar	5 bar	3 bar	5 bar	3 bar	5 bar
Water capacity:	155 Lpm	200 Lpm	310 Lpm	400 Lpm	620 Lpm	800 Lpm	1,550 Lpm	2,000 Lpm
k-factor:	89		178		358		895	
Approximate foam expansion ratio:	40:1		40:1		40:1		40:1	
Dimensions A:	710 mm		710 mm		830 mm		850 mm	
Dimensions B:	240 mm		240 mm		380 mm		380 mm	
Connection:	50 DIN PN 16 or 2 in. ANSI 150 lb		50 DIN PN 16 or 2 in. ANSI 150 lb		65 DIN PN 16 or 2 1/2 ANSI 150 lb		80 DIN PN 16 or 3 in. ANSI 150 lb	
Weight:	10 kg		10 kg		15 kg		15 kg	
Range of jet:	3 m to 5 m		3 m to 5 m		3 m to 5 m		3 m to 5 m	
Body material:	Stainless steel		Stainless steel		Stainless steel		Stainless steel	
Nozzle material:	Brass		Brass		Brass		Brass	
Range material:	Galvanized steel		Galvanized steel		Galvanized steel		Galvanized steel	

Note: The foam expansion ratio depends on the foam concentrate type.

Safety Data Sheets (SDS) are available at www.skum.com

Note: The converted values in this document are provided for dimensional reference only and do not reflect an actual measurement.

SKUM, and the product names listed in this material are marks and/or registered marks. Unauthorized use is strictly prohibited.